

County Wildlife Site Survey Form (Ref. No. 27)

Site Name: Brewer's Green
Grid reference: TM 104805
District: South Norfolk

Parish: Roydon
Area: 5.8ha
Survey date: Various dates 2018-19

Registered Common Number: CL 190

Habitat description:

A registered common (CL190) divided into three parts by the roads which traverse it. Each part contains large, open areas of neutral grassland with scattered trees, scrub and ponds.

Map showing the County Wildlife Site Bounday

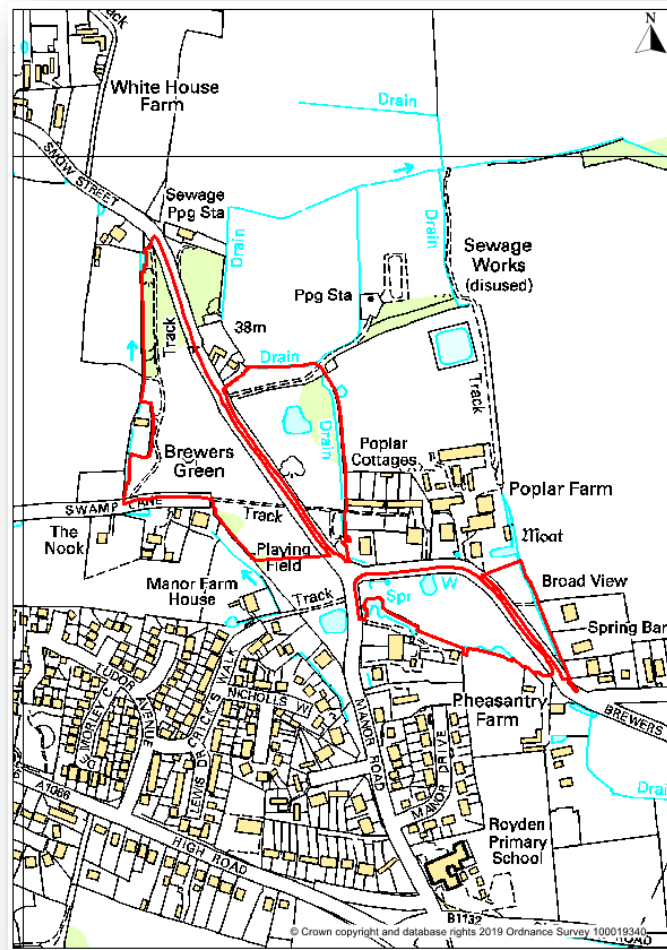

The grassland species across the common include yarrow (*Achillea millefolium*), agrimony (*Agrimonia eupatorium*), common bent (*Agrostis capillaris*), meadow foxtail (*Alopecurus pratensis*), sweet vernal grass (*Anthoxanthum odoratum*), false oat grass (*Arrhenatherum elatius*), cuckooflower (*Cardamine pratensis*), chalk knapweed (*Centaurea debeauxii*), cocksfoot (*Dactylis glomeratum*), wild carrot (*Daucus carota* ssp. *carota*), red fescue (*Festuca rubra* ssp. *rubra*), dyer's greenweed (*Genista tinctoria* ssp. *tinctoria*), Yorkshire fog (*Holcus lanatus*), meadow vetchling (*Lathyrus pratensis*), oxeye daisy (*Leucanthemum vulgare*), field woodrush (*Luzula campestris*), star of Bethlehem (*Ornithogalum umbellatum*),

smaller cat's tail (*Phleum bertolonii*), cowslip (*Primula veris*), fleabane (*Pulicaria dysenterica*), common sorrel (*Rumex acetosa*), meadow saxifrage (*Saxifraga granulata*), lesser stitchwort (*Stellaria graminea*), yellow oat grass (*Trisetum flavescens* ssp. *flavescens*), germander speedwell (*Veronica chamaedrys*), tufted vetch (*Vicia cracca*) and hairy tare (*Vicia hirsuta*).

Both the scarce dyer's greenweed, and meadow saxifrage, occurred as single plants in 2018.

The north of the common is an area of woodland, dominated by oak (*Quercus robur*) with bramble (*Rubus fruticosus* agg.), ash (*Fraxinus excelsior*), hawthorn (*Crataegus monogyna*), hazel (*Corlyus avellana*), dog's mercury (*Mercurialis perennis*), lords and ladies (*Arum maculatum*), false brome (*Brachypodium sylvaticum*), herb robert (*Geranium robertianum*), wood avens (*Geum urbanum*), hedge woodwort (*Stachys sylvatica*), greater stitchwort (*Stellaria holostea*) and ground ivy (*Glechoma hederacea*). The north-western part of the grassland was sprayed, ploughed and re-seeded in the late 1950s.

For purposes of surveying in 2018-19, the common was divided into three areas – Area X, Area Y and Area Z (see map below).

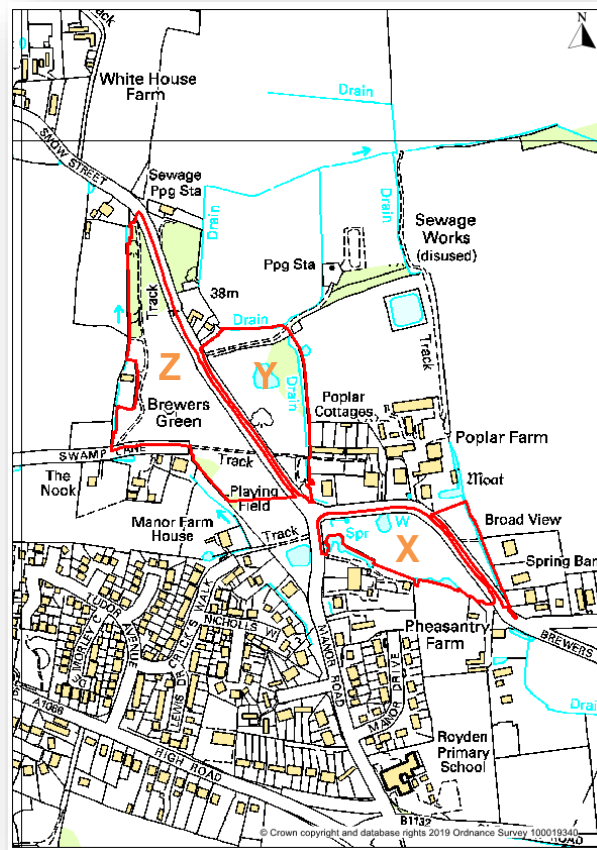

Area X is the south east section of the common is bordered on the west by Manor Road, and contains a low-lying area which is flooded in winter. The damper area has frequent common spike rush (*Eleocharis palustris* ssp. *vulgaris*), floating sweet grass (*Glyceria fluitans*) and marsh foxtail (*Alopecurus geniculataus*). The pond margin has a colony of narrow-leaved Michaelmas daisy (*Aster lanceolatus*) which has been present for at least 70 years. Area X is the main area of the common for tufted vetch, wild carrot, and meadow vetchling. A small area in the north-east is dominated by tall fescue (*Schedonorus arundinaceus*). The pond is backed to the south by a patch of scrub and trees.

The southern boundary of the grassland has a belt of scattered trees.

Area Y is the eastern side of the common. The neutral grassland has prominent narrow-leaved meadow grass (*Poa angustifolia*), smooth meadow grass (*Poa pratensis*) and downy oat grass (*Avenula pubescens*). Meadow brome (*Bromus commutatus*) is rare. One plant of meadow saxifrage was seen in 2018, while cowslip is occasional here.

The pond area has occasional cuckooflower, branched bur-reed (*Sparganium erectum*), jointed rush (*Juncus articulatus*) and abundant amphibious bistort (*Persicaria amphibia*). The pond is backed in the east by ash, willow (*Salix* sp.) and hawthorn, which continues part way along the eastern boundary of the common.

The extreme south of the grassland is kept closely mown with daisy (*Bellis perennis*) and slender speedwell (*Veronica filiformis*). The far north of area Y consists of a thicket of small trees and shrubs, with frequent sycamore (*Acer pseudoplatanus*), four Nootka cypress trees (*Xanthocyparis nootkatensis*) and a carpet of winter aconite (*Eranthis hyemalis*), snowdrop (*Galanthus nivalis*) and daffodils (*Narcissus* sp.).

Area Z is the western side of the common. The far northern end is trees and scrub, with an avenue of planted Lombardy poplar (*Populus nigra* 'Italica').

The southern semi-improved neutral grassland has frequent common bent, while an area further south towards Swamp Lane has dominant chalk knapweed with occasional cuckooflower, meadow foxtail, smaller cat's tail and, in 2018, contained a single plant of dyer's greenweed.

The western edge has an area of scattered trees becoming woodland, with hornbeam (*Carpinus betulus*), horse chestnut (*Aesculus hippocastanum*), white poplar (*Populus alba*), common whitebeam (*Sorbus aria*), Siberian crab (*Malus baccata*) and Jacquemont's birch (*Betula jacquemontii*). The ground flora is dominated by variegated archangel (*Lamium galeobdolon* ssp. *argenteum*).

South of Swamp Lane is an area of the common maintained as amenity grassland for a children's play area, with a splendid London plane (*Platanus x hispanica*).

The pond has planted water lily (*Nymphaea* sp.) and is backed to the west by scattered trees.

Target notes reference map:

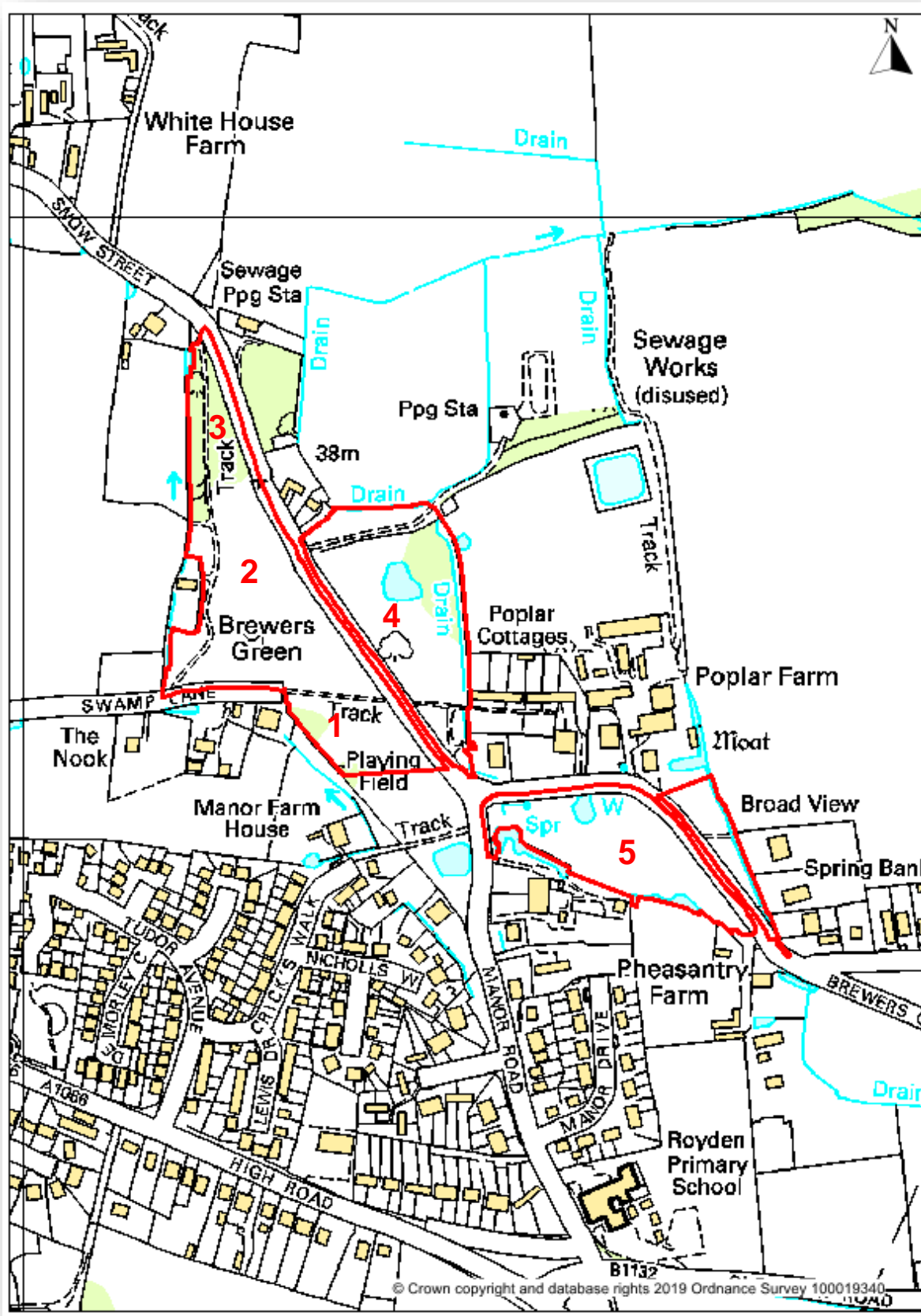

1. Part of this area is outside the CWS boundary - Open, grassy area used as a recreation area for locals; it is kept neatly mown short. This area has a striking, 70 year old + London plane tree, also planted ornamental maple, lime and beech trees.

The grassland here has similar species to the rest of the common but also more amenity grassland species including greater plantain (*Plantago major*), clover sp. (*Trifolium* sp.), pineappleweed (*Matricaria discoidea*), knotgrass (*Polygonum aviculare*) and other mowing and trample-tolerant species.

This grassland is bordered to the west with low garden-type hedge of blackthorn (*Prunus spinosa*), privet (*Ligustrum vulgare*) and hawthorn. The hedges also support some bramble, young sycamores and ashes.

The recreation area is separated by a track from the far southern tip of the common which has a pond with small patches of planted water lily, great willowherb (*Epilobium hirsutum*), hard rush (*Juncus inflexus*), false fox sedge (*Carex otrubae*), meadow buttercup (*Ranunculus acris*) and reed canary grass (*Phalaris arundinacea*), also ground elder (*Aegopodium podagraria*), bulrush (*Typha latifolia*) and coltsfoot (*Tussilago farfara*). The pond is edged with willows. A large hornbeam stands at the far southern tip and the grass here is kept short.

2. The north west area of grassland is allowed to grow long during the spring and summer, and in places is dominated by smaller cat's tail and chalk knapweed. An area of finer sward to the north supports knapweed, Yorkshire fog, tufted vetch, meadow vetchling, lesser stitchwort, Lady's bedstraw (*Galium verum*), star of Bethlehem, red fescue, and birdsfoot trefoil (*Lotus corniculatus*). Hogweed (*Heracleum sphondylium*) is occasional here, while ragwort (*Jacobaea vulgaris*) is rare. False oat grass is frequent, as is common bent in places. Meadow buttercup is occasional and bulbous buttercup (*Ranunculus bulbosus*) occurs by the roadside.

One small patch of dyer's greenweed occurs by a mown path, immediately east of a low hanging oak branch (in summer 2019).

Rosebay willowherb (*Chamaenerion angustifolium*) is confined to a medium-sized stand, south of the finer area.

This area of finer sward is said by a villager to be reminiscent of the old, less-improved grassland of the common.

Meadow foxtail is frequent, and cuckooflower is occasional in the area just north of the track to Swamp Lane.

An area of c.30 year old ornamental trees occurs to the north of Swamp Lane with variegated archangel dominating the ground flora. Trees here include Norway maple, horse chestnut, wild cherry (*Prunus avium*), hornbeam and white poplar. The white poplar is seeding into the main grassland area to the east.

3. Mixed woodland of ash, sycamore, oak, beech, elm, hawthorn and coppiced hazel. A deep, old ditch to the west is seasonally wet, and supports great willowherb, with willow and ash. Hawthorn occurs on the field side of the ditch, and seems to have been coppiced.

Greater stitchwort, false brome, hedge woundwort, herb Robert, wood avens, wood dock (*Rumex sanguineus*) and cow parsley (*Anthriscus sylvestris*) occur in the

ground flora. The trees here are about 30 years old but an avenue of planted Lombardy poplars is older.

Patches of low bramble occur in the wooded area, and there are taller stands of bramble to the south towards the grassland. Patches of dog's mercury occur, notably by the west boundary.

To the south of this area, there are young, planted trees in the grassland. Across the road, the small wooded area is dominated by sycamore, and the ground flora includes planted daffodils and aconites.

4. The eastern half of this grassland supports many of the same species as the rest of the common, such as knapweed, and carefully mown paths give a smart appearance and good access, even at the height of the growing season.

The grassland is becoming dominated by coarser grasses such as Yorkshire fog and false oat grass. Yellow rattle (*Rhinanthus minor*) has been introduced, and is coming to dominate in places.

The pond here has a stand of willow and bramble on its eastern bank, with trees beyond including ash, lime, beech, horse chestnut and ornamental maple. The pond itself has horned pondweed (*Zannichellia palustris*), but little other aquatic vegetation. The pond margins support water mint (*Mentha aquatica*), false fox sedge, branched bur-reed (*Sparganium erectum*), hairy sedge, gypsywort (*Lycopus europaeus*), jointed rush, hard rush, fleabane, glaucous sedge (*Carex flacca*), with a few birch and willow saplings on the west side. The pond supports dragonflies, damselflies, banded damoiselles (*Calopteryx splendens*), frogs (*Rana temporaria*) and toads (*Bufo bufo*).

A wide, water-filled ditch makes up the eastern boundary to this area, supporting little vegetation, being heavily shaded by mature trees. There were a few unidentifiable aquatic plants in baskets in the ditch, showing past attempts at management.

The grassland to the north of the track to the waterworks is coarser, and is used for storing road materials, and for piles of grass cuttings. The area is dominated by creeping thistle (*Cirsium arvense*), with false oat grass, spear thistle (*Cirsium vulgare*), sowthistle (*Sonchus sp.*) and Yorkshire fog.

5. The western end of this area is dominated by Yorkshire fog and false oatgrass with occasional tufted vetch, meadow buttercup and meadow vetchling. Cocksfoot is occasional, as are nettles (*Urtica dioica*).

The southern boundary is wooded along a deep old ditch and moat/pond (outside the boundary).

The pond here again supports little aquatic vegetation but some marginals grow well in the nearby seasonally wet grassland such as common spike rush, floating sweet grass, tufted forget-me-not (*Myosotis laxa*), marsh bedstraw (*Galium palustre*) and marsh foxtail.

A stand of narrow-leaved Michaelmas daisy has grown here for at least 70 years.

East of the pond, the grassland becomes coarser, and the area (over the road) is kept as rough grassland, with tall fescue dominating. Knapweed is rare, as is meadow buttercup. Field bindweed (*Convolvulus arvensis*), ribwort plantain (*Plantago*

WILDLIFE IN COMMON

lanceolata) and nettle occur in occasional patches. The area is less obviously maintained, with more quiet and undisturbed areas of growth, but is still accessible by a well-walked path.

Other notable species:

Include non-plant species eg turtle dove/barn owl/dingy skipper

For fauna records please see list below.

Adjacent habitats/potential buffer zones & linkage to other sites:

Brewer's Green is surrounded by agricultural land and housing.
Royden Fen (LNR) and Wortham Ling (SSSI) lie further south west, beyond the A1066.

Is the site in positive conservation management? Partly (Please give details if necessary).

The grassland is kept short mown in the south-west as a recreation area. Paths were cut through the other areas of longer grass, particularly in Area Y, to allow access across the common. Otherwise the grassland seems to be cut less often than in previous years. The southern pond appears more managed than the other two ponds.

Brief management proposals:

Cut and rake / remove cut material from grassland.

Continue to prevent the ponds from becoming overwhelmed by scrub and trees. Continue to manage the woodland through non-intervention.

Through the Wildlife in Common project a list of management suggestions was drafted in 2020.

Has a site condition assessment form been completed for this site? Yes

If not how would you rate the overall site condition?

Compartment number	Favourable/ no issues. Score 1	Favourable/ some issues Score 2	Recovering Score 3	Unfavourable – no change Score 4	Unfavourable - declining Score 5 (poor management)	Neglected Score 6 (no management)	Part destroyed/ Score 7	Destroyed Score 8
Overall Condition								

To be filled in by Conservation Officer

Final assessment of site:		Date:	
Habitat	Criteria passed on	Criteria failed on	Comments

Recommendations:

- ☐ Site remains CWS (boundary unchanged)
- ☐ Site deleted
- ☐ Boundary altered (specify)
.....
- ☐ Notify site as CWS

PLANT LIST

The map below references the location of specific plants mentioned in the plant list below.

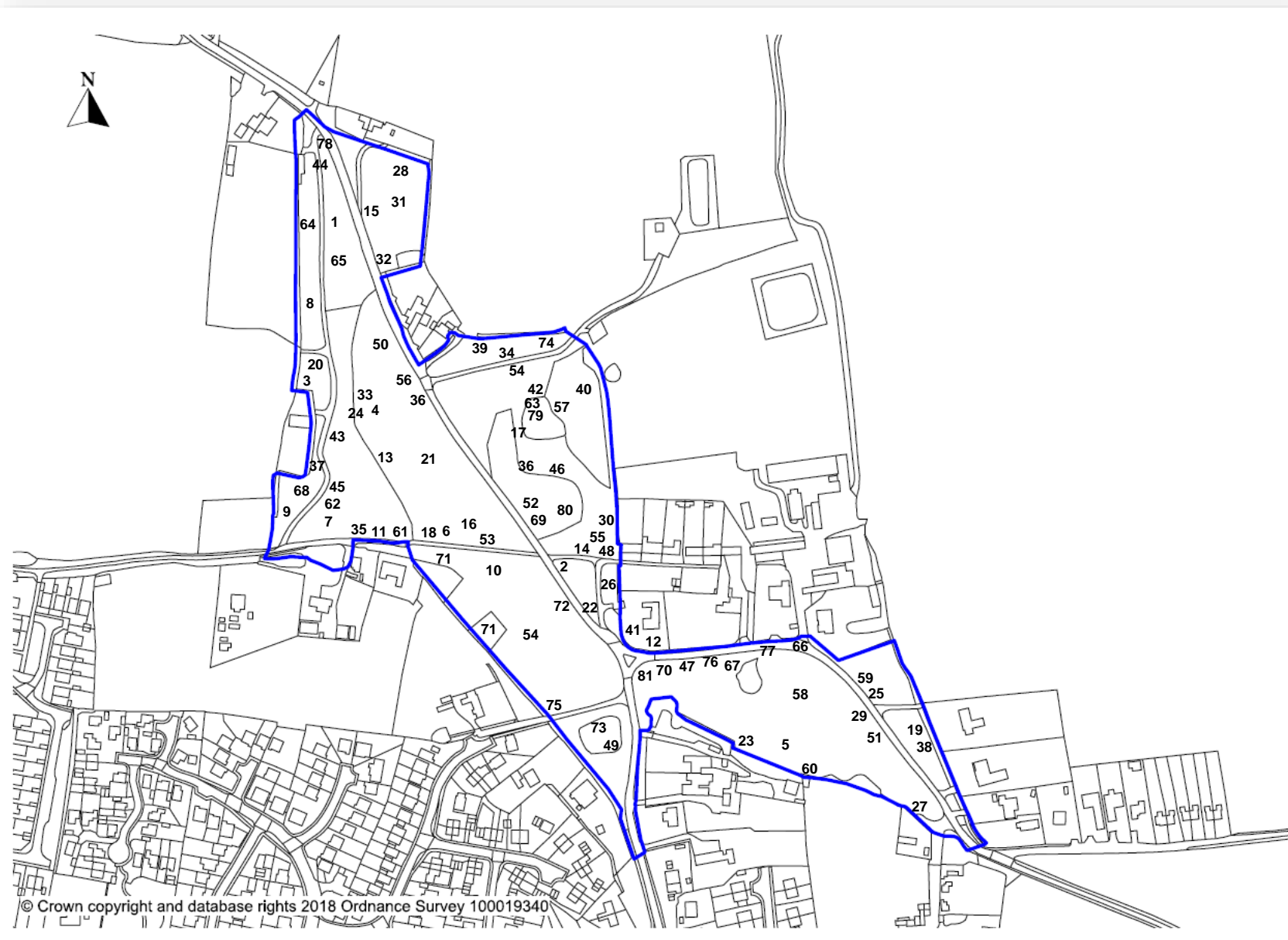

WILDLIFE IN COMMON

County Wildlife Site name & reference number: Brewer's Green CWS 27

Date of survey: 19/05/18, 12/06/18, 17/07/18, 03/08/18, 14/08/18 and 15/10/2018. 13/02/19, 24/02/19, 06/03/19, 15/03/19, 28/03/19, 07/05/19, 21/05/19, 22/05/19, 06/06/19, 16/06/19, 17/07/19, 05/08/19 and 22/09/19

Please note DAFOR is a way of showing the abundance of a species in an area. Where:

D = Dominant

A = Abundant

F = Frequent

O = Occasional

R = Rare (not many present)

Name of site:	BREWERS GREEN, ROYDON. DISS			
Surveyors:	Arthur Copping, Becky Whatley, Dave Weaver, Martin Courtier and Lucy Seely			
Common Name	Scientific Name	DAFOR	Map ref. point	COMMENT
Maple, Field	<i>Acer campestre</i>	O	1	
Maple, Norway	<i>Acer platanoides</i>	O	2	
Sycamore	<i>Acer pseudoplatanus</i>	O		
Yarrow	<i>Achillea millefolium</i>	O		
Ground Elder	<i>Aegopodium podagraria</i>	R		
Horse-chestnut	<i>Aesculus hippocastanum</i>	R		
Agrimony	<i>Agrimonia eupatoria</i>	O		
Corncockle	<i>Agrostemma githago</i>	R	3	NOT NATURALLY OCCURING.
Bent, Common	<i>Agrostis capillaris</i>	A	4	
Bent, Creeping	<i>Agrostis stolonifera</i>	O		
Plantain, Water	<i>Alisma plantago-aquatica</i>	R		
Garlic Mustard (aka Jack by the Hedge)	<i>Alliaria petiolata</i>	O		

WILDLIFE IN COMMON

Common Name	Scientific Name	DAFOR	Map ref. point	COMMENT
	<i>Alopecurus x Brachystylus</i>	R	5	Hybrid of the two succeeding
Foxtail, Marsh	<i>Alopecurus geniculatus</i>	F	5	
Foxtail, Meadow	<i>Alopecurus pratensis</i>	F	5/6	
Brome, Great	<i>Anisantha diandra</i>	O		
Brome, Barren	<i>Anisantha sterilis</i>	O		
Vernal-grass, Sweet	<i>Anthoxanthum odoratum</i>	F		
Parsley, Cow	<i>Anthriscus sylvestris</i>	A	7	
Columbine, Common	<i>Aquilegia vulgaris</i>	R		ONE PLANT.
Cress, Thale (aka Cress, Mouse-ear)	<i>Arabidopsis thaliana</i>	R		
Burdock, Lesser	<i>Arctium minus</i>	R	8	
False Oat Grass (aka Tall Oat Grass)	<i>Arrhenatherum elatius</i>	F		
Mugwort (aka Wormwood, Wild/Riverside)	<i>Artemisia vulgaris</i>	O		
Arum Lily (aka Lords-and-ladies / Cuckoo Pint)	<i>Arum maculatum</i>	O		
Orache, Common	<i>Atriplex patula</i>	R	9	
Oat	<i>Avena sativa</i>	R		ONE PLANT.
Downy Oat Grass	<i>Avenula pubescens</i>	O	36	
Black Horehound (aka Black Angelica)	<i>Ballota nigra</i>	O		ssp. <i>Merididnalis</i> .
Daisy, Common/English	<i>Bellis perennis</i>	F	2/10	
Birch, Himalayan	<i>Betula utilis</i> var. <i>Jacquemontii</i>	R	11	ONE PLANT
Bistort, Red	<i>Bistorta amplexicaulis</i>	R	12	ONE PLANT.
Broom, False (aka Wood brome/wood false-broom)	<i>Brachypodium sylvaticum</i>	O	8	
Oilseed Rape	<i>Brassica napus</i>	R		ONE PLANT.
Brome, Soft	<i>Bromus hordeaceus</i>	O		
Brome, Smooth	<i>Bromus racemosus</i>	R	13	ONE PLANT

WILDLIFE IN COMMON

Common Name	Scientific Name	DAFOR	Map ref. point	COMMENT
Bryony, White (<i>aka</i> Red Bryony)	<i>Bryonia dioica</i>	R		
Marigold, Common (<i>aka</i> Pot / Garden Marigold)	<i>Calendula officinalis</i>	R		
Bindweed, Hedge (<i>aka</i> Bellbind)	<i>Calystegia sepium</i>	O		
Bindweed, Hybrid	<i>Calystegia x lucana</i>	O	14	C. silvatica x sepium HYBRID
Peach-Leaved Bellflower	<i>Campanula persicifolia</i>	R	15	ONE PLANT.
Shepherd's purse	<i>Capsella bursa-pastoris</i>	R		
Bittercress, Hairy	<i>Cardamine hirsuta</i>	R		
Cuckoo flower (<i>aka</i> Lady's Smock)	<i>Cardamine pratensis</i>	O	16/17	
Thistle, Welled	<i>Carduus crispus ssp. multiflorus</i>	R	18	ONE PLANT.
Sedge, Glaucous	<i>Carex flacca</i>	O	17	
Sedge, Hairy (<i>aka</i> Goose Grass)	<i>Carex hirta</i>	A	17	
Sedge, False Fox	<i>Carex otrubae</i>	R	5	
Sedge, Pendulous	<i>Carex pendula</i>	R	19	
Hornbeam, Common / European	<i>Carpinus betulus</i>	R	11	
Chestnut, Sweet	<i>Castanea sativa</i>	R	20	
Cornflower	<i>Centaurea cyanus</i>	R	3	ONE PLANT.
Knapweed, Chalk	<i>Centaurea debeauxii</i>	A	21	
Mouse-ear, Common	<i>Cerastium fontanum ssp. Vulgare</i>	O		
Mouse-ear. Little	<i>Cerastium semidecandrum</i>	R	22	
Chervil, Rough	<i>Chaerophyllum temulum</i>	O	23	
Willowherb, Rosebay	<i>Chamaenerion angustifolium</i>	D	24	
Celandine, Greater	<i>Chelidonium majus</i>	R		
Fat-hen	<i>Chenopodium album</i>	R		
Thistle, Creeping	<i>Cirsium arvense</i>	O	25	
Thistle, Marsh	<i>Cirsium palustre</i>	R		
Thistle, Spear	<i>Cirsium vulgare</i>	R		

WILDLIFE IN COMMON

Common Name	Scientific Name	DAFOR	Map ref. point	COMMENT
Hemlock	<i>Conium maculatum</i>	R		
Bindweed, Field	<i>Convolvulus arvensis</i>	A		
Hazel, Common	<i>Corylus avellana</i>	R		
Hawthorn, Common	<i>Crataegus monogyna ssp. Nordica</i>	O		
Hawk's-beard, Smooth	<i>Crepis capillaris</i>	O		
Crocus	<i>Crocus sp.</i>	O	26/27	NOT NATURALISED
Cypress, Nootka	<i>Cupressus nootkatensis</i>	O	28	
Eastern Sowbread	<i>Cyclamen coum</i>	R	11	
Cocksfoot grass	<i>Dactylis glomerata</i>	O		
Wild Carrot	<i>Daucus carota</i>	O	29	
Tufted Hair Grass (<i>aka</i> Tussock Grass)	<i>Deschampsia cespitosa</i>	R		
Teasel, Wild/Common	<i>Dipsacus fullonum</i>	R		
Fern, Male (<i>aka</i> Basket Fern)	<i>Dryopteris filix-mas</i>	R	30	ONE PLANT.
Cockspur	<i>Echinochloa crus-galli</i>	R	30	ONE PLANT
Rush, Common Spike	<i>Eleocharis palustris</i>	F	5	
Couch, Common (<i>aka</i> Couch Grass)	<i>Elymus repens</i> (syn. <i>Elytrigia repens</i>)	O		
Willowherb, American	<i>Epilobium ciliatum</i>	R		
Willowherb, Great	<i>Epilobium hirsutum</i>	O	42	
Willowherb, Hoary	<i>Epilobium parviflorum</i>	R	17	
Horsetail	<i>Equisetum arvense</i>	R		
Aconite, Winter	<i>Eranthis hyemalis</i>	A	32	
Fleabane, Canadian (<i>aka</i> Horseweed)	<i>Erigeron canadensis</i> (syn. <i>Conyza canadensis</i>)	R		
Fleabane, Guernsey	<i>Erigeron sumatrensis</i> (syn. <i>Conyza sumatrensis</i>)	R	30	ONE PLANT.
Whitlowgrass, Common	<i>Erophila verna</i> agg.	R	30	ONE PLANT.

WILDLIFE IN COMMON

Common Name	Scientific Name	DAFOR	Map ref. point	COMMENT
Spurge, Sun	<i>Euphorbia helioscopia</i>	R	22	
Beech, Common	<i>Fagus sylvatica</i>	O		ONE TREE
Bindweed, Black	<i>Fallopia convolvulus</i>	R		
Fescue, Slender Creeping Red	<i>Festuca rubra</i>	F		
Fescue, Red	<i>Festuca rubra</i> spp. <i>Rubra</i>	F	4	
Celandine, Lesser	<i>Ficaria verna</i> (aka <i>Ranunculus ficaria</i>)	O		
Ash, Common	<i>Fraxinus excelsior</i>	R	1	
Snowdrop, Common	<i>Galanthus nivalis</i>	A	31	
Cleavers	<i>Galium aparine</i>	O		
Bedstraw, Common Marsh (aka Marsh-bedstraw)	<i>Galium palustre</i>	R	5	
Bedstraw, Lady's	<i>Galium verum</i>	O	4	
Dyer's Greenweed	<i>Genista tinctoria</i> ssp. <i>Tinctoria</i>	R	33	ONE PLANT
Crane's-Bill, Cut-Leaved	<i>Geranium dissectum</i>	O		
Crane's-Bill, Shining	<i>Geranium lucidum</i>	R		
Crane's-Bill, Meadow	<i>Geranium pratense</i>	R	34	
Crane's-Bill, Hedgerow	<i>Geranium pyrenaicum</i>	R	35	
Crane's-Bill, Druce's	<i>Geranium x oxonianum</i>	R	36	
Herb Robert	<i>Geranium robertianum</i>	O		
Wood Avens (aka Herb Bennet)	<i>Geum urbanum</i>	O		
Marigold, Corn	<i>Glebionis segetum</i> (Syn. <i>Chrysanthemum segetum</i>)	R	3	
Ground-ivy	<i>Glechoma hederacea</i>	O		
Sweet-grass, Floating	<i>Glyceria fluitans</i>	A	5	
Ivy, Common (aka English Ivy)	<i>Hedera helix</i>	O		
Bristly Oxtongue	<i>Helminthotheca echioides</i>	R	30	
Hogweed (aka Cow Parsnip)	<i>Heracleum sphondylium</i>	O		

WILDLIFE IN COMMON

Common Name	Scientific Name	DAFOR	Map ref. point	COMMENT
Yorkshire Fog	<i>Holcus lanatus</i>	O		
Barley, Two-row	<i>Hordeum distichon</i>	R		ONE PLANT.
Barley, Wall	<i>Hordeum murinum</i>	O		
Hop, Common	<i>Humulus lupulus</i>	R	37	
Bluebell, Hybrid	<i>Hyacinthoides x massartiana</i>	O		
Hyacinth	<i>Hyacinthus orientalis</i>	R	38/39	1 PLANT (in 38), 1 PLANT (in 39)
Cat's Ear	<i>Hypochaeris radicata</i>	O		
Iris, Stinking	<i>Iris foetidissima</i>	O	40	
Iris, Yellow Flag	<i>Iris pseudacorus</i>	R	41	
Ragwort	<i>Jacobaea vulgaris</i>	O		
Rush, Jointed/Joint Leaf	<i>Juncus articulatus</i>	R	17	
Rush, Toad	<i>Juncus bufonius</i>	R	17	
Rush, Soft/Common	<i>Juncus effusus</i>	O		
Rush, Hard	<i>Juncus inflexus</i>	O		
Archangel, Variegated yellow	<i>Lamium galeobdolon subsp. argentatum</i>	D	7	
Dead-nettle, White	<i>Lamium album</i>	O		
Dead-nettle, Red	<i>Lamium purpureum</i>	O		
Nipplewort	<i>Lapsana communis</i>	O	8	
Vetchling, Meadow	<i>Lathyrus pratensis</i>	O	29	
Daisy, Ox-eye	<i>Leucanthemum vulgare</i>	O		
Ryegrass, Italian	<i>Lolium multiflorum</i>	R		
Ryegrass, Perennial	<i>Lolium perenne</i>	O		
Bird's-foot-trefoil, Common	<i>Lotus corniculatus</i>	R	42	
Bird's-foot-trefoil, Greater	<i>Lotus pedunculatus</i>	O		
Honesty	<i>Lunaria annua</i>	R	43	
Wood-rush, Field	<i>Luzula campestris</i>	O		

WILDLIFE IN COMMON

Common Name	Scientific Name	DAFOR	Map ref. point	COMMENT
Gypsywort (<i>aka</i> Water horehound)	<i>Lycopus europaeus</i>	R	42	
Oregon Grape	<i>Mahonia aquifolium</i>	R	44	
Apple, Siberian crab	<i>Malus baccata</i>	R	45	
Apple, Common	<i>Malus pumila</i> (<i>syn. Malus domestica</i>)	O	46	
Mallow, Musk	<i>Malva moschata</i>	R	3	ONE PLANT. INTRODUCED?
Mallow, Dwarf	<i>Malva neglecta</i>	R	47	
Mallow, Common	<i>Malva sylvestris</i>	O		
Chamomile	<i>Matricaria chamomilla</i>	R	34	
Pineappleweed	<i>Matricaria discoidea</i>	R		
Medick, Black	<i>Medicago lupulina</i>	R	48	
Mint, Water	<i>Mentha aquatica</i>	O	17	
Mint, Apple	<i>Mentha x villosa</i>	R	27	
Mercury, Dog's	<i>Mercurialis perennis</i>	A	8	
Grape-hyacinth, Armenian	<i>Muscari armeniacum</i>	R		
Forget-me-not, Field	<i>Myosotis arvensis</i>	R		
Forget-me-not, Tufted	<i>Myosotis laxa</i>	R	5	ONE PLANT
Forget-me-not, Woodland	<i>Myosotis sylvatica</i>	R		
Water-cress, Narrow-fruited	<i>Nasturtium microphyllum</i>	R	17	
Daffodil	<i>Narcissus agg.</i>	O		
Waterlily, White	<i>Nymphaea alba</i>	R	49	
Star of Bethlehem, Common	<i>Ornithogalum umbellatum</i>	O	50	
Poppy, Common	<i>Papaver rhoeas</i>	R	34	
Poppy, Opium	<i>Papaver somniferum</i>	R	34	
Green Alkanet	<i>Pentaglottis sempervirens</i>	R		
Bistort, Amphibious	<i>Persicaria amphibia</i>	F	42	
Persicaria, Pale	<i>Persicaria lapathifolia</i>	R		
Redshank	<i>Persicaria maculosa</i>	R	9	

WILDLIFE IN COMMON

Common Name	Scientific Name	DAFOR	Map ref. point	COMMENT
Canary Grass, Reed	<i>Phalaris arundinacea</i>	R	81	
Cat's-tail, Smaller	<i>Phleum bertolonii</i>	F		
Timothy-grass	<i>Phleum pratense</i>	R		
Reed, Common	<i>Phragmites australis</i>	R	51	
Fox-and-Cubs (aka Orange Hawkweed)	<i>Pilosella aurantiaca</i>	R		
Plantain, Ribwort (aka Narrow-leaved Plantain)	<i>Plantago lanceolata</i>	O		
Plantain, Greater (aka Common Plantain / Broad-leaved)	<i>Plantago major</i>	O		
London Plane	<i>Platanus x hispanica</i>	R	54	
Meadow-grass, Narrow leaved	<i>Poa angustifolia</i>	F	52	
Meadow-grass, Annual	<i>Poa annua</i>	O		
Meadow-grass, Spreading	<i>Poa humilis</i>	O		
Meadow-grass, Smooth	<i>Poa pratensis</i>	O		
Meadow-grass, Rough-stalked	<i>Poa trivialis</i>	F	8	
Knotgrass, Common (aka Prostrate Knotgrass)	<i>Polygonum aviculare</i>	O		
Knotgrass, Equal-leaved (aka Common Knotweed)	<i>Polygonum depressum</i> (syn. <i>Polygonum arenastrum</i>)	R		ONE PLANT.
Bent Grass, Water	<i>Polypogon viridis</i>	R	30	ONE PLANT.
Poplar, White	<i>Populus alba</i>	R	11	
Poplar, Lombardy	<i>Populus nigra 'Italica'</i>	O	8 to 44	Lining both sides of track
Poplar, Grey	<i>Populus x canescens</i>	R	45	ONE PLANT.
Silverweed	<i>Potentilla anserina</i>	O		
Cinquefoil, Creeping	<i>Potentilla reptans</i>	A	53	
Cowslip, Common	<i>Primula veris</i>	O	26/36	
Primrose, Common	<i>Primula vulgaris</i>	R		ONE PLANT.
Selfheal	<i>Prunella vulgaris</i>	O		

WILDLIFE IN COMMON

Common Name	Scientific Name	DAFOR	Map ref. point	COMMENT
Cherry, Wild	<i>Prunus avium</i>	R	11	ONE PLANT
Cherry Plum	<i>Prunus cerasifera</i>	R	27	ONE PLANT.
Plum	<i>Prunus domestica</i>	R	43	
Blackthorn (<i>aka</i> Sloe)	<i>Prunus spinosa</i>	O		
Fleabane, Common	<i>Pulicaria dysenterica</i>	O	42	
Lungwort, Common	<i>Pulmonaria officinalis</i>	R	41	
Oak, English / Common	<i>Quercus robur</i>	O		
Buttercup, Meadow	<i>Ranunculus acris</i>	F		
Buttercup, Bulbous	<i>Ranunculus bulbosus</i>	F		
Buttercup, Creeping	<i>Ranunculus repens</i>	O		
Buttercup, Celery-leaved	<i>Ranunculus sceleratus</i>	R	17	
Weld (<i>aka</i> Dyer's Rocket)	<i>Reseda luteola</i>	R		
Yellow-rattle	<i>Rhinanthus minor ssp. Minor</i>	A	54	Spreading rapidly
Dewberry	<i>Rubus caesius</i>	O		
Blackberry, (Bramble)	<i>Rubus fruticosus</i>	O		
Blackberry, Elm-leaf / Thornless	<i>Rubus ulmifolius</i>	O		
Sorrel, Common / Garden	<i>Rumex acetosa</i>	O		
Dock, Clustered	<i>Rumex conglomeratus</i>	R	5	
Dock, Curled	<i>Rumex crispus</i>	R		
Dock, Broad-leaved	<i>Rumex obtusifolius</i>	R		
Dock, Wood (<i>aka</i> Bloody Dock)	<i>Rumex sanguineus</i>	O	8	
Pearlwort, Procumbent	<i>Sagina procumbens</i>	R	55	
Willow, Goat	<i>Salix caprea</i>	R	56	
Willow, Grey	<i>Salix cinerea</i>	O	57	
Willow, Crack / Brittle	<i>Salix fragilis</i>	O	58	SALIX X FRAGILIS - HYBRID CRACK-WILLOW
Elder	<i>Sambucus nigra</i>	O		

WILDLIFE IN COMMON

Common Name	Scientific Name	DAFOR	Map ref. point	COMMENT
Saxifrage, Meadow	<i>Saxifraga granulata</i>	R	80	
Fescue, Tall	<i>Schedonorus arundinaceus</i> - (Syn. <i>Festuca arundinacea</i>)	A	59	
Glory of the Snow	<i>Scilla forbesii</i>	R	60	ONE PLANT.
Hawkbit, Autumn	<i>Scorzoneroides autumnalis</i> (<i>Leontodon autumnalis</i>)	O		
Figwort, Water	<i>Scrophularia auriculata</i>	R		
Groundsel, Common	<i>Senecio vulgaris</i>	O		
Campion, Red	<i>Silene dioica</i>	R	3	
Campion, Hybrid (Red & White cross)	<i>Silene x hampeana</i> (<i>Silene latifolia</i> x <i>dioica</i>)	R	3	ONE PLANT.
Campion, White	<i>Silene latifolia</i>	R		
Mustard, Hedge	<i>Sisymbrium officinale</i>	O		
Alexanders	<i>Smyrniolum olusatrum</i>	A	61	
Nightshade, Black	<i>Solanum nigrum</i> ssp. <i>nigrum</i>	R	9	
Sowthistle, Perennial	<i>Sonchus arvensis</i>	O		
Sowthistle, Prickly / Spiny	<i>Sonchus asper</i>	O		
Sowthistle, Common / Smooth	<i>Sonchus oleraceus</i>	O		
Whitebeam	<i>Sorbus aria</i>	R	62	ONE PLANT
Rowan (aka Mountain Ash)	<i>Sorbus aucuparia</i>	R	61	
Bur-weed, Branched	<i>Sparganium erectum</i>	A	63	ssp. <i>Neglectum</i>
Woundwort, Hedge	<i>Stachys sylvatica</i>	O	64	
Stitchwort, Lesser	<i>Stellaria graminea</i>	O		
Stitchwort, Greater	<i>Stellaria holostea</i>	O	65	
Chickweed, Common	<i>Stellaria media</i>	O		
Chickweed, Lesser	<i>Stellaria pallida</i>	O	22/66	
Narrow-leaved Michaelmas Daisy	<i>Symphyotrichum lancesolatum</i>	O	67	
Comfrey, Hidcote	<i>Symphytum x hidcotense</i>	R	74	

WILDLIFE IN COMMON

Common Name	Scientific Name	DAFOR	Map ref. point	COMMENT
Comfrey, White	<i>Symphytum orientale</i>	R		
Comfrey, Russian	<i>Symphytum x uplandicum</i>	O	68	
Lilac, Common	<i>Syringa vulgaris</i>	R	69	
Tansy	<i>Tanacetum vulgare</i>	O	70	
Dandelion agg.	<i>Taraxacum officinale</i> agg.	O		
Lime, Common, (aka Linden)	<i>Tilia x europaea</i>	O	71	
Hedge-parsley, Upright	<i>Torilis japonica</i>	O	72	
Goat's-beard	<i>Tragopogon pratensis</i>	R		ssp. Minor
Trefoil, Lesser	<i>Trifolium dubium</i>	O	55	
Clover, Red	<i>Trifolium pratense</i>	O		
Clover, White	<i>Trifolium repens</i>	O		
Mayweed, Scentless	<i>Tripleurospermum inodorum</i>	R	34	
Oatgrass, Yellow	<i>Trisetum flavescens</i>	O		
Wheat	<i>Triticum aestivum</i>	R		ONE PLANT
Coltsfoot	<i>Tussilago farfara</i>	R	73	
Elm, Wych	<i>Ulmus glabra</i>	O	65	
Elm, Field	<i>Ulmus minor</i>	O	65	
Nettle, Stinging (aka Common Nettle)	<i>Urtica dioica</i>	O		
Mullein, Great	<i>Verbascum thapsus</i>	R		ONE PLANT.
Speedwell, Wall / Field	<i>Veronica arvensis</i>	O	22	
Brooklime	<i>Veronica beccabunga</i>	D	30	
Speedwell, Germander (aka Birdseye Speedwell)	<i>Veronica chamaedrys</i>	O		
Speedwell, Slender	<i>Veronica filiformis</i>	R	2/75	
Speedwell, Ivy-leaved [pale blue flowers with blue anthers]	<i>Veronica hederifolia</i> subsp. <i>hederifolia</i>	R	76	

WILDLIFE IN COMMON

Common Name	Scientific Name	DAFOR	Map ref. point	COMMENT
Speedwell, Ivy-leaved [whitish/pale lilac flowers & whitish/pale blue anthers]	<i>Veronica hederifolia subsp. lucorum</i>	O	76/77	
Speedwell, Common Field	<i>Veronica persica</i>	O	47	
Speedwell, Grey Field	<i>Veronica polita</i>	O	47	
Speedwell, Thyme-leaved	<i>Veronica serpyllifolia</i>	O		
Vetch, Common Tufted (<i>aka</i>	<i>Vicia cracca</i>	O		
Vetch, Common [pods usually hairless & brown to black]	<i>Vicia sativa subsp. segetalis</i>	O		
Periwinkle, Greater	<i>Vinca major</i>	R	78	
Periwinkle, Lesser	<i>Vinca minor</i>	R		
Violet, Sweet	<i>Viola odorata</i>	O		PATCHES SCATTERED AROUND THE GREEN
Dog-violet, Early	<i>Viola reichenbachiana</i>	R	60	ONE PLANT.
Pondweed, Horned	<i>Zannichellia palustris</i>	A	79	

Fauna Records

DRAGONFLY AND DAMSELFLY LIST

Date	Common Name	Scientific Name	Comments
20/07/19	Emperor Dragonfly	<i>Anax imperator</i>	
20/07/19	Banded Demoiselle	<i>Calopteryx splendens</i>	
20/07/19	Azure Damselfly	<i>Coenagrion puella</i>	
20/07/19	Small Red-eyed Damselfly	<i>Erythromma viridulum</i>	
20/07/19	Broad-bodied Chaser	<i>Libellula depressa</i>	
20/07/19	Four-spotted Chaser	<i>Libellula quadrimaculata</i>	
20/07/19	Common Blue Damselfly	<i>Polyommatus icarus</i>	
20/07/19	Ruddy Darter	<i>Sympetrum sanguineum</i>	
20/07/19	Common Darter	<i>Sympetrum striolatum</i>	

MAMMAL LIST

Date	Common Name	Scientific Name	Comments
Sept. 18	Serotine bat	<i>Eptesicus serotinus</i>	
31/05/ and 15/11/19	Hedgehog	<i>Erinaceus europaeus</i>	Dead
Sept. 18	Daubenton's bat	<i>Myotis daubentonii</i>	
Sept. 18	Natterer's bat	<i>Myotis nattereri</i>	
Sept. 18	Leisler's bat	<i>Nyctalus leisleri</i>	
Sept. 18	Noctule bat	<i>Nyctalus noctula</i>	
Sept. 18	Brown long-eared bat	<i>Plecotus auritus</i>	
Sept. 18	Common pipistrelle	<i>Pipistrellus pipistrellus</i>	
Sept. 18	Soprano pipistrelle	<i>Pipistrellus pygmaeus</i>	

BIRD LIST

Date	Common Name	Scientific Name	Comments
Nov 2019	Grey Heron	<i>Ardea cinerea</i>	
May 2019	Barn Owl	<i>Tyto alba</i>	

AMPHIBIAN AND REPTILE LIST

Date	Common Name	Scientific Name	Comments
19/03/19	Common toad	<i>Bufo bufo</i>	Spawning
14/03/19	Common frog	<i>Rana temporaria</i>	Spawning

Bat Survey – Carried out in 2018



Bat Survey results for TM1080 from 3 survey nights

Below you can find a summary of the main findings from your bat survey visits. Further information for individual visits can be found on the following pages.

The total number of recordings per night:



Bat species detected:

Our provisional analysis of the recordings detected the following species. The numbers relate to the number of bat passes rather than the number of individual bats.

Species	Total number of passes (all nights)
Brown long-eared bat	3
Common pipistrelle	586
Daubenton's bat	2
Leisler's bat	5
Natterer's bat	6
Noctule	9
Serotine	12
Soprano pipistrelle	11

Below are details of recordings that could not be assigned with confidence to a single species.

Species	Total number of passes (all nights)
Leisler's bat or Noctule	2
Myotis species	1
Pipistrelle species	34

Note: Pipistrelle species = this refers to a recording of a bat in the genus *Pipistrellus* that cannot be identified to species. In the UK, possible species include Common Pipistrelle, Soprano Pipistrelle and Nathusius' Pipistrelle. Myotis species = this refers to a recording of a bat in the genus *Myotis* that cannot be identified with confidence to species. In the UK this includes Natterer's, Daubenton's, Whiskered, Brandt's, Alcahoie bat and Bechstein's

Photos (by Becky Whatley)



Amenity grassland with mature trees



'The Molly pond', north east of the common



The southern pond, to the south of
Swamp Lane



The pond to the south east of the
common



Dyer's greenweed



View south on the parallel road
from Bressingham to Roydon,
South facing



Path through wooded area with
avenue of poplars

Example of flora on the common by Joanna Smith

